

# DXN 200

## Ice Machine/Dispenser 110 kg

Item #:
Project:
Quantity:



### FEATURES

- Compact ice or ice & water automatic dispenser, with appealing, contemporary "touch-screen" design.
- Ideal for free-refill self-service concepts with up to 2400 glasses filled per day and capable of dispensing ice for up to 200 customers in queue at one time.
- Available either touch-free or button activated.
- Possible to set ice only or ice & water on site and desired ice dosage (from 1" to 15" or continuous).
- Fast & friendly cleaning mode for the end user.
- Algorithm signaling when reservoir is temporarily empty.
- Full frontal visibility of settings and errors for preventative service check-up.
- Accessory: on request, it can be installed upon a specifically designed cabinet.



DXN 200  
Cubelet 1 g  
W 16 x D 15 x H 7-8 mm

### CONDENSING SYSTEM

Air cooled

### REFRIGERANT GAS

R452A

### VOLTAGE V/Hz/ph

230/50/1

### INTERNAL BIN CAPACITY

10 kg

### CERTIFICATIONS



### OPERATING REQUIREMENTS

	Minimum	Maximum
Air temperature	10	38
Water temperature	5	38
Water pressure	1 bar (14 psi)	5 bar (70 psi)
Electrical voltage	-10%	+10%

**IMPORTANT NOTICE:**  
Models and specifications are subject to change without notice.  
This spec sheet is meant for commercial purpose only.  
For technical documentation please refer to our service manuals.

Download our free **App Scotsman Ice**  
Apple store  
Google play  
Windows store



[www.scotsman-ice.it](http://www.scotsman-ice.it)  
[www.scotsman-ice.com](http://www.scotsman-ice.com)

Ice Machine/Dispenser 110 kg

# DXN 200

Ice Machine/Dispenser 110 kg

Item #:
Project:
Quantity:

Ice Machine/Dispenser 110 kg

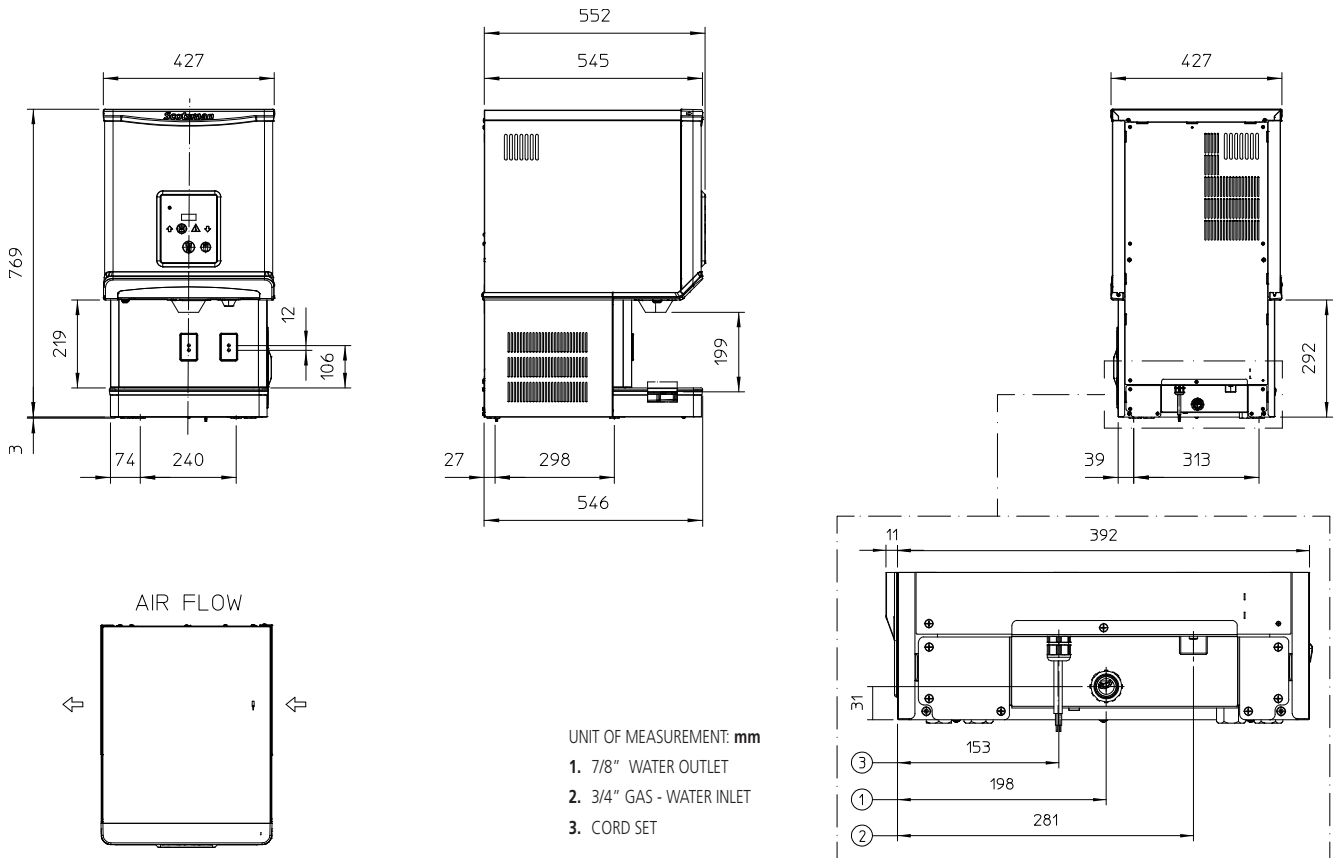

UNIT DATA		SHIPPING DATA									
Size (W x D x H)	427 x 552 x 772 mm	Carton (W x D x H)	490 x 610 x 940 mm								
Net weight	53 kg	Weight	61 kg								
		24 h ice production kg °C Amb. / °C Water			Energy consumption (*)		Water usage (*)	Instant power	Compressor	Circuit wires	Max. fuse size
Version	Voltage	10°C/10°C	21°C/10°C	32°C/21°C	kWh/100 kg	kWh/24h	l/h	W	W	No. x Ømm <sup>2</sup>	A
DXN 200 AS	230/50/1	110	92	65	23.1	15.0	2.7	670	1300	3 x 1.5	10

(\*) Data refer to 32°C Amb. / 21°C Water temperature conditions